

# LC Switchable Uniboot Connector

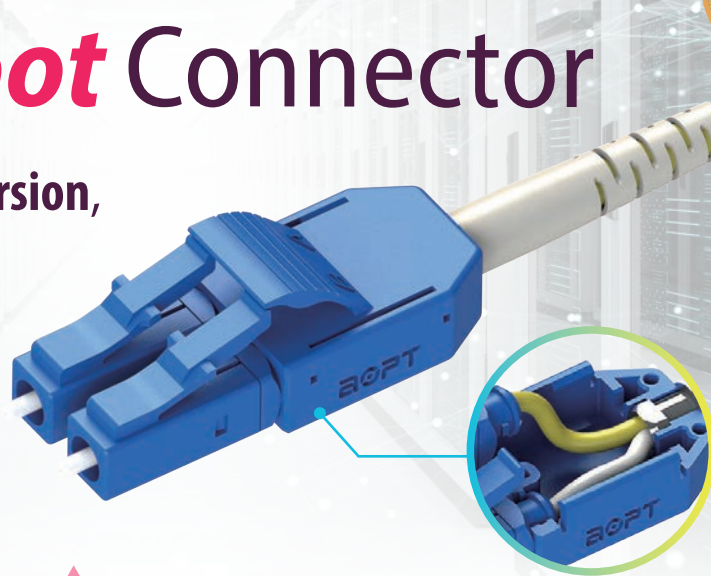

Easy and Quick Polarity Conversion, Maximizing Space with Uniboot Design.



Standard 12F

Uniboot 12F

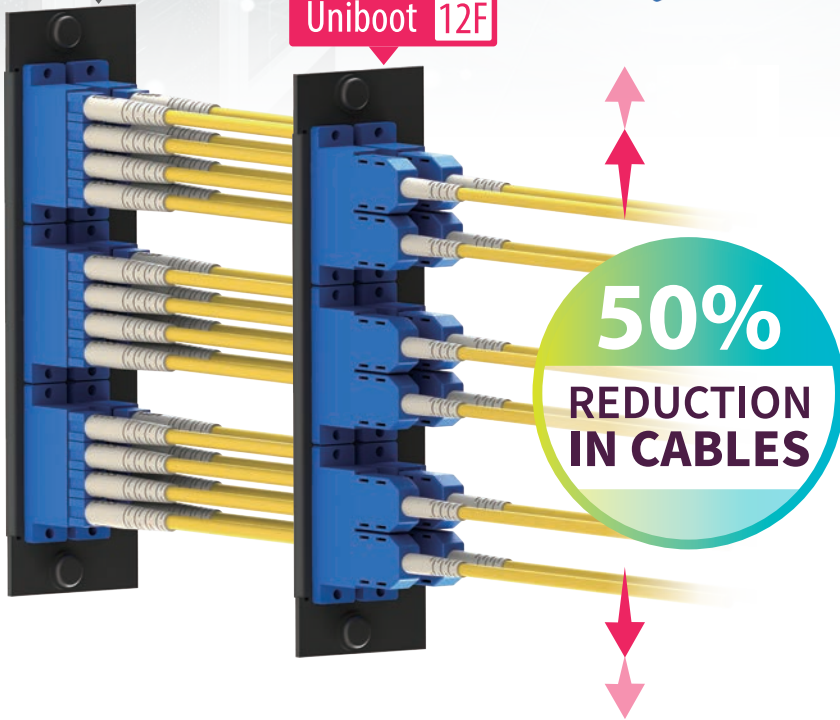

## FEATURES

- Easy Polarity Reversal.
- Uniboot design is essential for maximizing space savings of up to 50%.
- Uniboot assists in cable management.
- Boot types available for 2.0mm and 4.8mm diameter

## APPLICATIONS

- Data communications
- Telecommunications
- FTTx deployments
- Optical measurement instruments
- 4G/LTE, 5G base station
- CATV

## SWITCH POLARITY

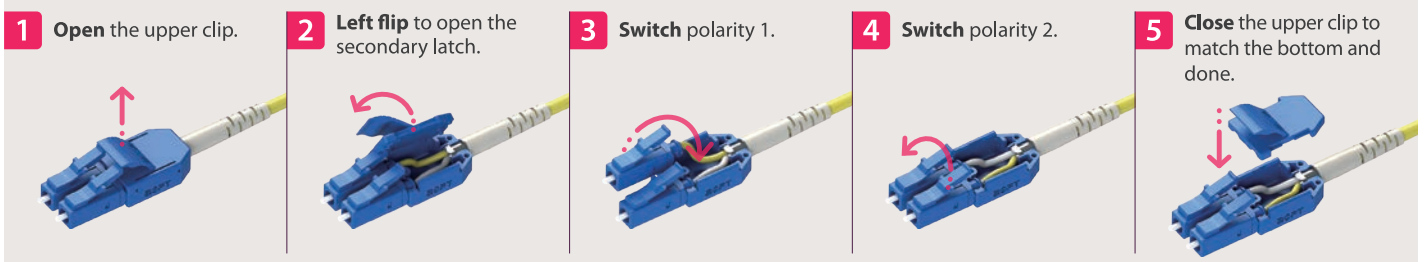

### ACON OPTICS COMMUNICATIONS INC.

#### TAIWAN-HEADQUARTER

5F, No.4, Aly. 9, Ln. 45, Baoxing Rd., Xindian Dist., New Taipei City 231, Taiwan  
Tel:+886-2-2917-7668  
contactus@aconoptics.com

#### CHINA-TIANJIN

No.32, Taixiang Road, TEDA, Tianjin, China.  
Tel:+86-22-6633-2010  
contactus@aconoptics.com

#### CHINA-SHENZHEN

No. 2, Lanjing Middle Road, Pingshan District, Shenzhen City, Guangdong, China  
Tel:+86-755-3382-8888  
contactus@aconoptics.com

#### AMERICA

#### Advanced-Connectek U.S.A. Inc.

3002 Dow Ave, Suite 506, Tustin, California 92780, U.S.A.  
Tel: +1-714-573-1920  
info@acon-us.com

www.aconoptics.com